

PCI-10S-RS-R40

10-Slot Backplane with 4 PCI and 5 ISA Bus User Manual Ver. 4.0

1. PW2: ATX Power Connector

| Pin | Description | Pin | Description |
|-----|-------------|-----|-------------|
| 1 | +3.3Vdc | 11 | +3.3Vdc |
| 2 | +3.3Vdc | 12 | -12Vdc |
| 3 | GND | 13 | GND |
| 4 | +5Vdc | 14 | PS-ON |
| 5 | GND | 15 | GND |
| 6 | +5Vdc | 16 | GND |
| 7 | GND | 17 | GND |
| 8 | PWR-OK | 18 | -5Vdc |
| 9 | +5VSB | 19 | +5Vdc |
| 10 | +12Vdc | 20 | +5Vdc |

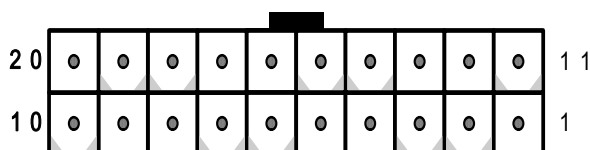

2. PW1: AT Power Connector

| Pin | Description | Pin | Description |
|-----|-------------|-----|-------------|
| 1 | PWRGD | 7 | GND |
| 2 | +5V | 8 | GND |
| 3 | +12V | 9 | -5V |
| 4 | -12V | 10 | +5V |
| 5 | GND | 11 | +5V |
| 6 | GND | 12 | +5V |

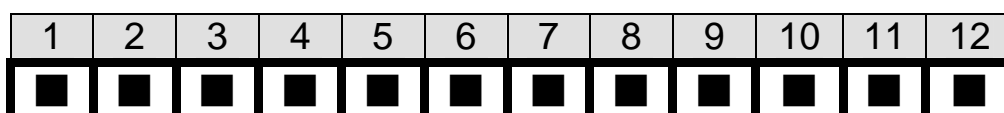

3. ATXCTL1: Backplane to Mainboard Connector

| Pin | Description |
|-----|-------------|
| 1 | GND |
| 2 | PSON# |
| 3 | 5VSB |

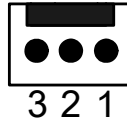

4. FAN1, FAN2: Fan Connector

| Pin | Description |
|-----|-------------|
| 1 | GND |
| 2 | +12V |
| 3 | NC |

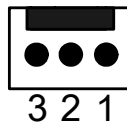

5. CN1: Voltage Connect

| Pin | Description |
|-----|-------------|
| 1 | +5V |
| 2 | -5V |
| 3 | -12V |
| 4 | +12V |
| 5 | GND |

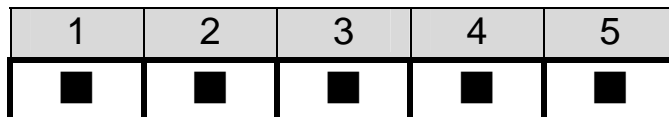

6. Notice:

- a. Recommend to use 6mm width spacer to install

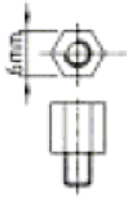

- b. Torsion must less than 6lb-inch

7. Dimension

